

ITEM QTY	DESCRIPTION	RATIOS				SGL PLANETARY				DOUBLE PLANETARY			
		4:1	5:1	19.24:1	28.32:1	33.80:1	38.00:1	38.00:1	45.00:1	45.00:1	45.00:1	45.00:1	
MODEL 130L													
	1	E130 - SQUARE FLANGE			81-004-0392								
	1	E130 - RECTANGULAR			81-004-0392								
	1	F130 - FLANGELESS			81-004-3072								
	1	C130 - CUSTOM			81-004-1142								
	1	D1 23 T 8/16 DP SPT 2.25" LG			81-004-0992L								
	1	D2 3.000" DIA. 5/8" SQ KEY			81-004-1412L								
	1	D3 23 T 8/16 DP SPT 1.227" LG			81-004-0942L								
	1	D4 23 T 8/16 DP SPT 2.277" LG			81-004-1152L								
	1	D5 3.500" DIA. 7/8" SQ KEY											
	1	SAE A 2 & MOD. 4 BOLT			13-004-1252	13-004-1192	13-004-1222	13-004-1222	13-004-1192	13-004-1222	13-004-1222	13-004-1222	13-004-1222
	1	SAE A 2 & MOD. 4 BOLT W/ CODE 4			13-004-1252	13-004-1252	13-004-1222	13-004-1222	13-004-1252	13-004-1222	13-004-1222	13-004-1222	13-004-1222
	1	SAE B 2 & 4 BOLT W/ CODE 4			13-004-1202	13-004-1182	13-004-1232	13-004-1232	13-004-1182	13-004-1232	13-004-1232	13-004-1232	13-004-1232
	1	SAE C 2 BOLT & BOLT			13-004-1212	13-004-1232	13-004-1232	13-004-1232	13-004-1212	13-004-1232	13-004-1232	13-004-1232	13-004-1232
	1	SAE D 2 BOLT W/ CODE 9			13-004-1212	13-004-1212	13-004-1212	13-004-1212	13-004-1212	13-004-1212	13-004-1212	13-004-1212	13-004-1212
	1	CODE 2 - INPUT - 13 T 1632 DP			13-004-1282	13-004-1282	13-004-1312	13-004-1312	13-004-1302	13-004-1312	13-004-1312	13-004-1312	13-004-1312
	1	CODE 3 - INPUT - SAE 1-86			13-004-1322	13-004-1322	13-004-1472	13-004-1472	13-004-1332	13-004-1472	13-004-1332	13-004-1382	13-004-1382
	1	CODE 4 - INPUT - 14 T 1224 DP			13-004-1342	13-004-1342	13-004-1362	13-004-1352	13-004-1442	13-004-1382	13-004-1382	13-004-1382	13-004-1382
	1	CODE 5 - INPUT - 15 T 1632 DP			13-004-1442	13-004-1452	13-004-1802		13-004-1442	13-004-1802	13-004-1802	13-004-1802	13-004-1802
	1	CODE 9 - INPUT - 13 T 816 DP			13-004-1021	13-004-1512							
	1	CARRIER ASSEMBLY-SECONDARY			13-005-2001	13-005-2001	13-005-2011	13-005-2011	13-005-2011	13-005-2011	13-005-2011	13-005-2011	13-005-2011
	1	CARRIER (SECO)			13-004-0621	13-004-1072	13-004-1082	13-004-1072	13-004-1072	13-004-1072	13-004-1072	13-004-1072	13-004-1072
	1	PLANET GEAR (SECO)			13-004-1082	13-004-1092	13-004-1082	13-004-1092	13-004-1092	13-004-1092	13-004-1092	13-004-1092	13-004-1092
	1	PLANET SHAFT (SECO)			81-004-0061								
	1	BRG - SEC. PL.			01-105-0500								
	1	THRUST WASHER - PLANET			81-004-1561								
	1	ROLL PIN - SEC. PL. 3/16 X 7/8			01-153-0210								
	1	SUN GEAR			13-004-142	13-004-1152	13-004-142	13-004-1152	13-004-1152	13-004-1152	13-004-1152	13-004-1152	13-004-1152
	1	CARRIER ASSEMBLY-PRIMARY			13-005-2021	13-005-2021	13-005-2041	13-005-2041	13-005-2031	13-005-2041	13-005-2041	13-005-2041	13-005-2041
	1	CARRIER (PRI)			13-004-1032	13-004-1032	13-004-1042	13-004-1042	13-004-1042	13-004-1042	13-004-1042	13-004-1042	13-004-1042
	1	PLANET GEAR (PRI)			13-004-1102	13-004-1102	13-004-1122	13-004-1112	13-004-1112	13-004-1112	13-004-1112	13-004-1112	13-004-1112
	1	BRG - PRI. PL.			01-105-0500								
	1	THRUST WASHER - PLANET			81-004-1561								
	1	ROLL PIN - PRI. PL. 1/8 X 7/8			01-153-0180								
	1	RING GEAR			81-004-2362								
	1	THRUST WASHERS & THRUST BRGS			81-004-2711								
	1	CARRIER THRUST WASHER			81-004-2711	81-004-2711	81-004-2711	81-004-2711	81-004-2711	81-004-2711	81-004-2711	81-004-2711	81-004-2711
	1	CARRIER THRUST WASHER			81-004-2883	81-004-2701	81-004-2701	81-004-2701	81-004-2701	81-004-2701	81-004-2701	81-004-2701	81-004-2701
	1	THRUST WASHER SGL. PL.			01-112-0030								
	1	BEARING											
	1	THRUST RACE											
	1	SEAL KIT											
	1	SHAFT SEAL - O-RING			81-016-2941								
	1	SHAFT SEAL - O-RING			01-405-0270								
	1	SHAFT SEAL - O-RING			01-402-0420								
	1	OUTPUT SHAFT BEARINGS											
	1	OUTER CONE			01-102-0620								
	1	OUTER CUP			01-103-0620								
	1	INNER CONE			01-102-0030								
	1	INNER CUP			01-103-0030								
	1	HARDWARE											
	1	BOLTS - COVER			01-150-1670	FOR 13-004-1412 COVER USE 01-150-1710 SHCS)							
	1	LOCKWASHERS - COVER			01-166-0010	FOR 13-004-1412 COVER DO NOT USE LOCKWASHERS)							
	1	BOLTS - RING			01-190-1460								
	1	HARD WASHERS - RING			01-166-0120								
	1	PLUGS / GREASE ZERK											
	1	PLUG - COVER			01-207-0070								
	1	PLUG - RING			01-207-0041								
	1	1/4 NPT (SOCC. HD.)			01-207-0020								
	1	GREASE FITTING			01-215-0040								
	1	MISCELLANEOUS											
	1	SHIMS											
	1	SPLIT RING			81-004-1151	(* QUANTITY DETERMINED BY PRELOAD REQUIRED AND PART STACK-UP)							
	1	LOCK RING			81-004-8101								
	1	RETAINING RING			81-004-8111								

... SAE D 2 COVER IS SOLD ONLY WITH A CODE 9, 13 T, 816 INPUT GEAR.

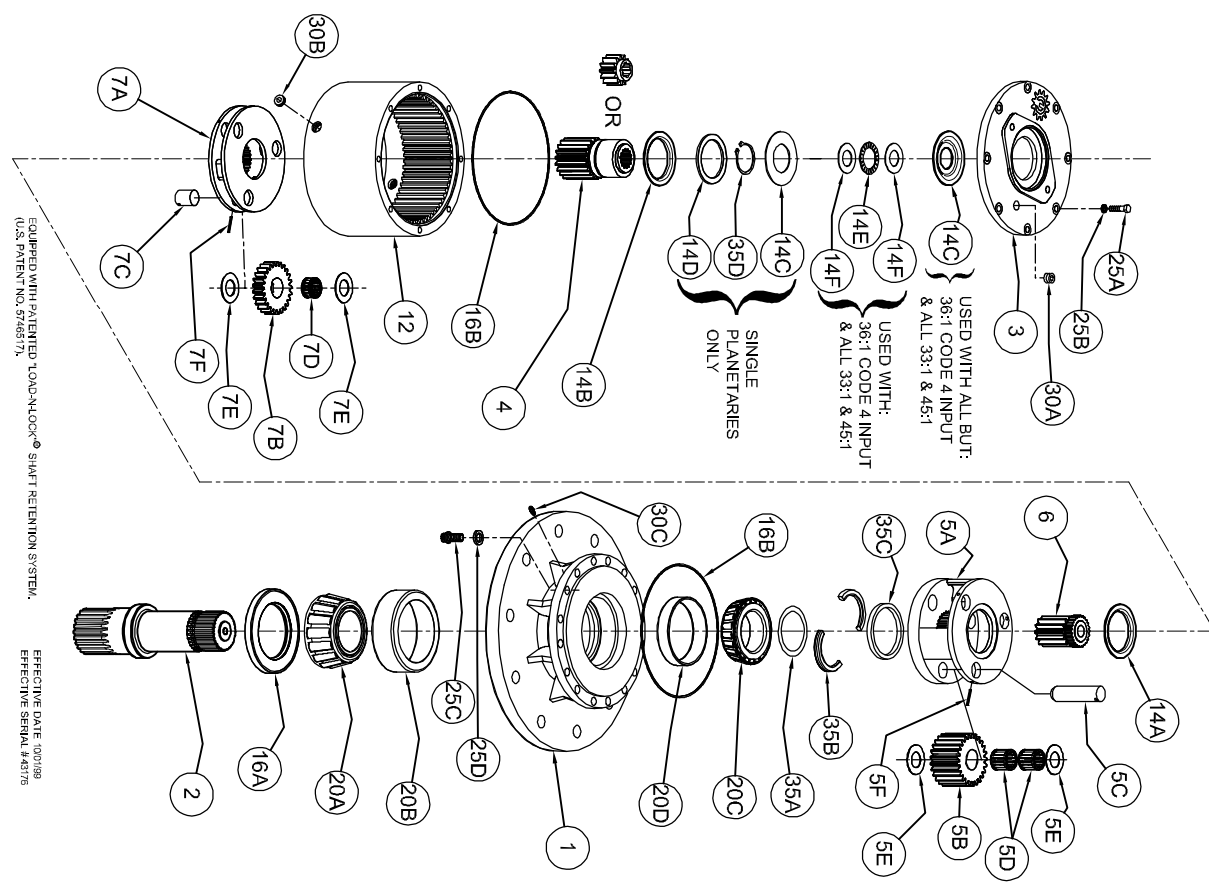

EQUIPPED WITH PATENTED™ LOCK-LOCK® SHIM RETENTION SYSTEM,
(U.S. PATENT NO. 5746917)

X130LD2-AH DATE 10-22-12
ECN 3483E

EFFECTIVE DATE: 10/1/99
EFFECTIVE SERIAL: 64876